

INTRODUCING

OASIS *of the* SEASSM

WE BUILD INCREDIBLE



INTRODUCING SIX OF SEVEN AMAZING NEIGHBORHOODS:
BOARDWALK, CENTRAL PARK, ROYAL PROMENADE, POOL & SPORTS ZONE, VITALITY AT SEA SPA & FITNESS, ENTERTAINMENT PLACE



IF ALL THE WORLD'S A STAGE...

LET'S GIVE OURS AN OCEAN VIEW

Our imagination and innovation has no boundaries. For us a ship isn't just a ship, but rather, a collection of amazing experiences that challenge all limitations. Our new *Oasis of the Seas*SM exemplifies how we continue to break the mold time and again – and how we undertake new endeavors.

Quickly, the impossible becomes possible and the unimaginable becomes real; entertainment areas become neighborhoods and suites become lofts. We are Royal Caribbean International® and we build incredible.



WE BUILD NATURE

CENTRAL PARKSM

Introducing the first neighborhood concept - Central Park is a revolutionary public space combining nature with nautical.

Elegant and lively, Central Park's piazza is the ship's town square, which evolves from a tranquil and peaceful atmosphere during the day to a gathering space for dining, entertainment, and street performances in the evening.

Central Park features several alfresco dining options and more than 300 staterooms, which rise six decks to overlook the Park.

Quiet reading corners, specimen gardens, and other hidden surprises await guests among the winding paths.

Bringing the outdoors in, Central Park offers guests a tranquil outdoor space, open to the sky, like never seen before.

WE BUILD NEIGHBORHOODS

CENTRAL PARKSM

At the center of the ship, the innovative design of Central Park opens to the sky and features lush tropical grounds spanning more than the length of a football field.

- Neighborhood Features:

- Themed garden spaces offering a wide variety of tropical foliage

- Dining / Entertainment Venues:

- Chops Grille - our signature steak house

- 150 Central Park - exclusive dining

- Antonio's Table - Italian trattoria

- Park Café - indoor/outdoor gourmet market

- Vintages - our ever popular wine bar

- Bar - featuring the Crystal Canopy

- Rising Tide bar - the first levitating bar at sea

- Boutique Shopping:

- Upscale specialty gift store

- The Parkside Gallery - showcasing original artwork

- Picture This - a unique portrait studio

- New Accommodations:

- 254 Central Park View balcony staterooms

- 70 Central Park View staterooms

WE BUILD NEIGHBORHOODS

CENTRAL PARKSM



Park View balcony staterooms overlooking Central Park

WE BUILD NEIGHBORHOODS

CENTRAL PARKSM



Vintages wine bar

WE BUILD NEIGHBORHOODS

CENTRAL PARKSM



Antonio's Table Italian trattoria



Boleros Latin bar

WE BUILD CITIES

ROYAL PROMENADE

The Royal Promenade neighborhood - the most expansive promenade at sea - continues to be the heart of the ship. Except now, it's better than ever. For the first time, the Royal Promenade will have a mezzanine level that overlooks the space below and adds to the excitement of the Promenade.

It features Rising Tide; a levitating bar that ascends and descends over three decks, and enough shops and restaurants to entertain even the most traveled of travelers. By morning, enjoy a relaxed atmosphere over coffee, and people watch. The ambiance becomes more energetic and vibrant in the afternoon with shopping, lunch, or drinks in the pub. In the evening, the energy rises with parades, nightlife, and entertainment for everyone. It's a destination unto itself.

WE BUILD NEIGHBORHOODS

ROYAL PROMENADE

The Royal Promenade continues to be the heart of the ship, with one exciting central area for guests to gather, dine, shop and be entertained.

- Neighborhood Features:

- Mezzanine level
- Promenade Bridge

- Dining /Entertainment Venues:

- Sorrento's Pizzeria
- Mondo Coffee Bar
- Café Promenade - signature café
- Rising Tide bar - the first levitating bar at sea
- Globe and Atlas Pub
- Schooner Bar
- Boleros - Latin bar
- Champagne Bar

- Shopping/Services:

- Fine jewelry, cosmetics, gifts, souvenirs and more
- Guest Services and Explorations!
- A Close Shave - men's salon
- Focus - photo gallery

- Accommodations:

- 18 Promenade View staterooms

WE BUILD NEIGHBORHOODS

ROYAL PROMENADE



View of the Royal Promenade from the mezzanine

WE BUILD NEIGHBORHOODS

ROYAL PROMENADE



Royal Promenade featuring a Crystal Canopy skylight

WE BUILD NEIGHBORHOODS

ROYAL PROMENADE



Schooner Bar

WE BUILD NEIGHBORHOODS

ROYAL PROMENADE



Champagne Bar

WE BUILD NEIGHBORHOODS

ROYAL PROMENADE



Boleros Latin bar



WE BUILD AMUSEMENT

BOARDWALKSM

featuring AquaTheater

Dedicated to family fun and nostalgia, the new groundbreaking Boardwalk neighborhood is a slice of old-world charm with a modern twist. Introducing the one-of-a-kind AquaTheater and the first ever Carousel at sea, Boardwalk offers enough games, amusement and attractions to keep everyone entertained.

Surrounded by casual restaurants, including Johnny Rockets® and the Seafood Shack, a coffee and donut shop, bars, candy shop and more, Boardwalk is the place to be for the entire family.

Kids and teens can shop for the latest trends while everyone enjoys a spin on the Carousel. Boardwalk is the place for kids and kids at heart.

WE BUILD NEIGHBORHOODS

BOARDWALKSM

featuring AquaTheater

Bringing the best of seaside entertainment onboard, the Boardwalk provides an interactive experience for the entire family, offering fun food and engaging entertainment.

• Neighborhood Features:

AquaTheater

Carousel

Two Rock-Climbing Walls

• Dining/Entertainment Venues:

Johnny Rockets® - diner

Seafood Shack - casual seafood restaurant

Boardwalk Donut Shop

Ice Cream Parlor

Boardwalk Bar

Madame Zamara's - psychic and tattoo parlor

• Shopping:

Candy Beach

Star Pier and Pinwheels - kids and teen retail

Smile - novelty photo shop

• New Accommodations:

6 AquaTheater View suites

221 Boardwalk View balcony staterooms

8 Boardwalk View staterooms

WE BUILD NEIGHBORHOODS
BOARDWALKSM



Boardwalk View Balcony Staterooms overlooking the Carousel and Boardwalk

WE BUILD NEIGHBORHOODS

BOARDWALKSM



Boardwalk looking aft

WE BUILD NEIGHBORHOODS

BOARDWALKSM



Boardwalk looking forward

WE BUILD NEIGHBORHOODS

BOARDWALKSM



Boardwalk View balconies

WE BUILD NEIGHBORHOODS
BOARDWALKSM



The Carousel and Candy Beach

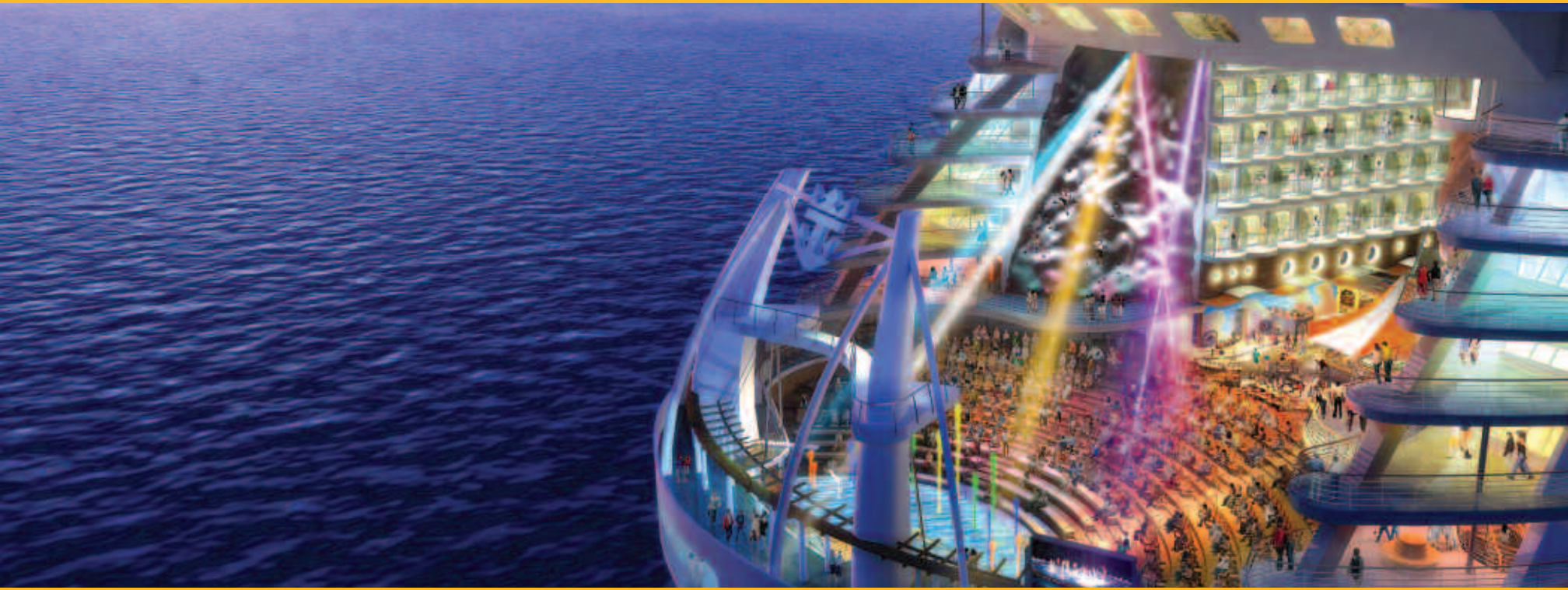

WE BUILD NEIGHBORHOODS

BOARDWALKSM *featuring AquaTheater*

Warm sunrays and flying acrobats - it all takes place center stage at the AquaTheater. Daytime, guests can unwind or socialize poolside, go for a dip, or take in the rays while relaxing on the sundeck. As the sun sets, loungers become theater seating. Guests trade their sunblock for evening cocktails, and water acrobats mesmerize audiences with high-diving aerial performances. Theatergoers are dazzled by the spectacular water show, set against the backdrop of the ocean and horizon, under a star lit sky. Six decks of balconies that overlook the theater or Boardwalk offer private views of the show.

- Pool by day, theater by night
- Seating for more than 600 theatergoers
- Stunning ocean views
- Anchored on either side by a pair of rock-climbing walls

WE BUILD NEIGHBORHOODS

BOARDWALKSM *featuring AquaTheater*



AquaTheater



WE BUILD REJUVENATION

VITALITY AT SEA SPA AND FITNESS

A place to soothe mind, body and soul, this state-of-the-art setting designed for the healthy lifestyle, combines the most advanced spa and anti-aging therapies, the latest fitness equipment and healthy dining options.

Enjoy the benefits of a relaxing massage or share the experience in one of our many couples massage suites. Restore your body in our Thermal Suite or rejuvenate with one of our many pampering Spa treatments.

If you're looking to energize your body, then head to our fitness center. Try the latest equipment or one of several classes, including spinning, Pilates, yoga and our new Kinesis™ class: a full-body, no-impact workout.

Hungry? Then stop by the new Vitality Café where you'll find healthy snacks, juices and smoothies, plus nutritious entrées. The Vitality at Sea Spa and Fitness Neighborhood is perfect place to strengthen your body, soothe your mind, and renew your spirit.

WE BUILD REJUVENATION

VITALITY AT SEA SPA AND FITNESS

The new Vitality at Sea Spa and Fitness neighborhood supports your healthy lifestyle, combining the latest in aesthetic skin treatments, traditional spa services and workout programs. Reconnect with your inner strength and renew your body inside and out.

• Spa Features:

Solo and couples massage suites

In room massages

Thermal Suite – heated tile loungers, saunas and steamrooms

Beauty Salon – complete hair, nail and make-up services

Youth Spa – dedicated space for kids and teens

Vitality Café - healthy selections including smoothies, snacks and entrées

• Fitness Features:

158 state-of-the-art cardio and resistance machines

Free weight area

Studio fitness classes, including kickboxing, Pilates, yoga and others

Spacious spin class area

Kinesis – the newest, most innovative form of resistance exercise designed to burn 30% more calories while improving posture and flexibility

Largest jogging track at sea that is partly covered to protect from the elements

WE BUILD REJUVENATION

VITALITY AT SEA SPA AND FITNESS



Vitality at Sea Fitness Center

WE BUILD REJUVENATION

VITALITY AT SEA SPA AND FITNESS



Entrance to Vitality at Sea Spa & Fitness

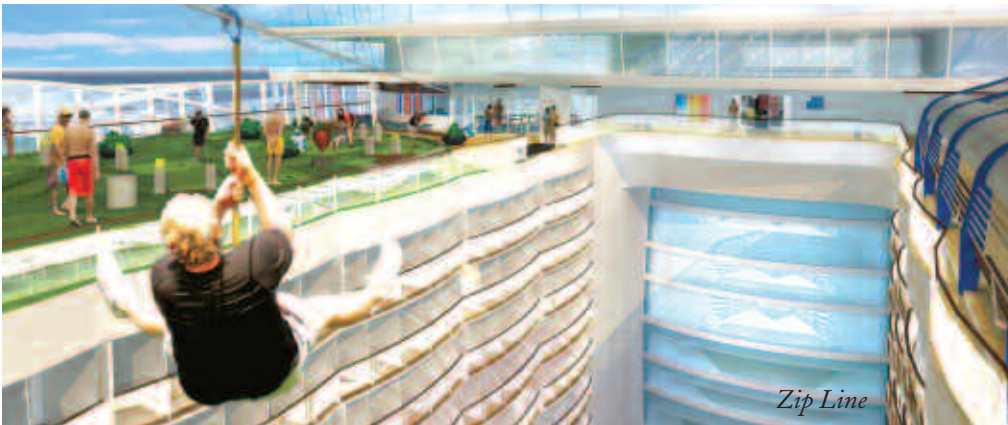

WE BUILD EXHILARATION

POOL & SPORTS ZONE

More options than you can imagine! A fun filled zone for all ages – it takes up an entire deck with multiple pools, rock-climbing walls, miniature golf, ping pong, two FlowRiders® and a basketball court. All this, plus amazing views of BoardwalkSM and Central ParkSM below.

Choose from four pools; the H2O Zone, where kids can enjoy a giant octopus with its water-spraying tentacles and a separate wading pool for infants and toddlers; the sports pool, dedicated for laps and watersports or the new beach pool, with a sloped entry that simulates wading into the ocean. Lounge by the traditional pool, now surrounded by private cabanas and more sun loungers than any other ship afloat.

When you've worked up a thirst, stop by one of four bars or retreat to cool off in our grandest Solarium yet. Surrounded by glass and standing two decks high, this is the perfect place for adults to relax. The new Solarium Bistro offers sit-down dining areas with healthy entrées, and at night it transforms into a unique specialty restaurant.

And don't miss the ultimate, spine-tingling rush – riding on the Zip Line! There's nothing like zooming over the BoardwalkSM, a mere nine decks below.

WE BUILD EXHILARATION

POOL & SPORTS ZONE

Set high above the family fun and excitement of the Boardwalk and the serenity of Central Park, the Pool and Sports Zone offers everyone a place to play, satisfy a sense of adventure – or simply relax and bask in the sun.

- Pool Area:

- H2O Zone – aqua park for kids and families

- Sports Pool – for lap swimming and watersports

- Beach Pool – sloped ocean-like entry

- Main Pool – perfect for simply sunbathing and taking a dip

- Private Cabanas

- 10 total whirlpools, eight whirlpools and two cantilevered whirlpools

- Four bars – Sand Bar, Pool Bar, Mast Bar and Sky Bar

- Solarium – a tranquil adult environment featuring plush seating and loungers, the Solarium pool, two traditional whirlpools and two cantilevered whirlpools

- Solarium Bistro – good-for-you breakfasts and lunches by day, a healthy specialty restaurant by night

- Sports Deck:

- Two FlowRider® surf simulators

- Zip Line – a thrilling experience which takes riders across the open-air atrium suspended nine decks

- Sports court – for basketball, volleyball, ping pong and more

- Miniature golf course

- Wipe Out Bar – adjacent to the FlowRiders®

- Wipe Out Café – overlooking the sports court and offering a full bar and casual dining

WE BUILD EXHILARATION

POOL & SPORTS ZONE



Pool deck

WE BUILD EXHILARATION

POOL & SPORTS ZONE



Sports deck

WE BUILD EXHILARATION

POOL & SPORTS ZONE



H2O Zone

WE BUILD EXHILARATION

POOL & SPORTS ZONE



Solarium

WE BUILD EXHILARATION

POOL & SPORTS ZONE



Beach pool



Comedy Live

WE BUILD APPLAUSE

ENTERTAINMENT PLACE

Introducing Entertainment Place, a neighborhood filled with more entertainment options than you can imagine. Here you'll find a mix of large, pulsating spaces and smaller, intimate venues that deliver a variety of entertainment every night.

Play your favorite game of chance at the elegant Casino Royale, which rivals any land based Casino in style and sophistication. Enjoy one-of-a-kind ice shows and a variety of themed events throughout the week at Studio B. Or take in a show at the Opal Theater, with our most dramatic and spectacular stage yet.

If you feel like moving to the latest club music, there's Blaze, the hottest nightclub at sea. Or get cozy at Jazz on 4. And for late-night laughs, head to Comedy Live.

Then there's Dazzles. From big band to disco, Dazzles offers countless fresh musical experiences – complete with dancing lessons and competitions.

Now that's entertainment!

WE BUILD APPLAUSE

ENTERTAINMENT PLACE

With more choices than ever before, Entertainment Place is your stop for casino thrills, show-stopping theater, laugh-it-up comedy and much more.

• Entertainment Place Features:

Casino Royale – 450 slot machines, 27 table games (including blackjack, roulette and craps), a poker room, and a bar/lounge area

Studio B – one-of-a-kind ice shows, guest ice skating and other themed events

Opal Theater – a 1,380-seat venue offering two original production shows and one headliner show each week

Blaze nightclub – the latest in dance music with a large dance floor, huge oval bar and private seating areas

Jazz on 4 – intimate jazz and blues lounge featuring live music nightly

Comedy Live – family shows, late-night adult comedy and specialty comedy acts

• More Entertainment Options

Dazzles (Decks 8, 9 and 10) – spectacular musical experiences with themes ranging from big band to disco

AquaTheater (Boardwalk) – a pool by day, this beautiful 600-seat theater transforms at night featuring stunning water acrobatics and high-diving aerial performances

On the Promenade Deck:

Boleros – Latin dance club playing the latest rhythms and serving specialty Latin drinks.

On Air Club – bar offering karaoke, and interactive music gaming

Schooner Bar – sing-along piano bar

WE BUILD APPLAUSE

ENTERTAINMENT PLACE



Opal Theater

WE BUILD APPLAUSE

ENTERTAINMENT PLACE



Opal Theater

WE BUILD APPLAUSE

ENTERTAINMENT PLACE



Opal Theater

WE BUILD APPLAUSE

ENTERTAINMENT PLACE



Casino RoyaleSM

WE BUILD APPLAUSE

ENTERTAINMENT PLACE



Jazz on 4

WE BUILD APPLAUSE

ENTERTAINMENT PLACE



Blaze nightclub

WE BUILD APPLAUSE

ENTERTAINMENT PLACE



Blaze nightclub

WE BUILD APPLAUSE

ENTERTAINMENT PLACE



Comedy Live

WE BUILD APPLAUSE

ENTERTAINMENT PLACE



Comedy Live

WE BUILD RELAXATION

LOFT SUITES

Urban living has made its way onboard with multilevel lofts featuring spacious accommodations which can be combined to offer up to 2,000 square feet of living space. The new suites redefine cruising accommodations with their spacious living areas and double height ceilings. The Lofts boast an open, contemporary design with vibrant, ocean-inspired colors in a sophisticated setting. Floor-to-ceiling windows provide breathtaking views while letting in natural light. Sea breezes caress guests on spacious balconies that offer a retreat and spot to lounge. Guests are treated to a private spa-like experience in their bathrooms, which are outfitted with rain shower heads, natural stone and glass tile accents. You'll feel pampered in your own private sanctuary at sea.

Crown Loft suite



WE BUILD RELAXATION

LOFT SUITES



Crown Loft suite balcony, and bathroom

WE BUILD RELAXATION

LOFT SUITES



Royal Loft suite



Central Park View balcony staterooms

WE BUILD NEIGHBORHOODS

ROOMS WITH A VIEW

We have reinvented the definition of cruise ship accommodations. Beyond traditional staterooms, some offering great ocean views, guests now have an unprecedented selection of accommodations to choose from:

Accommodations

Lofts

Royal Loft Suite • Sky Loft Suites • Crown Loft Suites

Suites

*AquaTheater Suites • Royal Suite • Presidential Suite
Owner's Suites • Family Suites • Grand Suites
Junior Suites*

Family

*Family Suites • Family Balcony Oceanviews
Family Oceanviews • Family Inside Staterooms*

Central Park

Central Park Balcony • Central Park View Staterooms

Boardwalk

Boardwalk Balcony • Boardwalk View Staterooms

Royal Promenade

Promenade View Staterooms

Staterooms

*Standard Balcony • Oceanview
Inside Staterooms*

Italicized = new classes of accommodations.

WE BUILD NEIGHBORHOODS

ROOMS WITH A VIEW



Boardwalk View balcony staterooms

WE BUILD NEIGHBORHOODS

ROOMS WITH A VIEW



AquaTheater suites have private balconies with views of the AquaTheater and the Boardwalk

WE BUILD NEIGHBORHOODS

ROOMS WITH A VIEW



Promenade View staterooms

WE BUILD MEMORIES

MORE UNIQUE FEATURES



With flying guests, levitating bars, and floating bridges you'll need to suspend your disbelief before you turn the page.

WE BUILD INNOVATION

RISING TIDE BAR

Like the ocean's tides, the Rising Tide bar moves slowly up and down between three decks, effortlessly transporting its patrons from indoors to outdoors. Guests enjoy cocktails as they gradually ascend into Central Park, while below the bar, fountains entertain. After a brief stop in Central Park, the bar heads back down through public spaces arriving back at Royal Promenade. One minute guests are under the sun, or stars, and the next they're surrounded by Royal Promenade's strollers. The floating bar features an open space with cocktail tables and seating areas encircled in a crystal veranda. Rising Tide bar is all the buzz, offering you a unique cocktail experience that takes drinks to a whole new level.



WE BUILD INNOVATION

ZIP LINE

The Sports Deck offers a new thrilling experience, the Zip Line... Strap on your sense of adventure and enjoy an exhilarating trip while suspended nine decks above the Boardwalk. Guests race diagonally across the open air atrium. During their thrilling journey, they will get a unique view as they fly from one end of Boardwalk to the other for a heart-pumping ride. Brace yourself for a spine tingling rush featuring a bird's eye view of all *Oasis of the Seas*SM has to offer.



PROMENADE BRIDGE

A unique focal point of the Royal Promenade is the Promenade Bridge, an impressive world globe, sculptured in shining metal. Prominently displayed above the Globe and Atlas Pub, the globe unravels to reveal an awe-inspiring platform suspended 10 feet high during the Promenade's entertainment festivities.





STARTING LATE 2009

**7 NIGHT
EASTERN
CARIBBEAN
CRUISE**



Eastern Caribbean only
December 2009
through April 2010

Day	Port *	Arrive	Depart
Sat.	Fort Lauderdale, Florida	—	5:00 pm
Sun.	Cruising	—	—
Mon.	Cruising	—	—
Tue.	Charlotte Amalie, St. Thomas	7:00 am	6:00 pm
Wed.	Philipsburg, St. Maarten	7:00 am	5:00 pm
Thu.	Cruising	—	—
Fri.	Nassau, Bahamas	1:00 pm	7:00 pm
Sat.	Fort Lauderdale, Florida	7:00 am	—

**7 NIGHT
WESTERN
CARIBBEAN
CRUISE**



Alternating Western
and Eastern Caribbean
beginning May 2010

Day	Port *	Arrive	Depart
Sat.	Fort Lauderdale, Florida	—	5:00 pm
Sun.	Cruising	—	—
Mon.	Labadee, Haiti	8:00 am	5:00 pm
Tue.	Falmouth, Jamaica	10:00 am	6:00 pm
Wed.	Cruising	—	—
Thu.	Cozumel, Mexico	8:00 am	8:00 pm
Fri.	Cruising	—	—
Sat.	Fort Lauderdale, Florida	7:00 am	—

**Itineraries are subject to change without notice.*

WE BUILD ANTICIPATION...

***Oasis of the Seas*SM has seven neighborhoods;
we've uncovered the first six!**

**Look for more details and further reveals at
OasisoftheSeas.com**

All images of Oasis of the SeasSM are artistic renderings and reflect proposed design and layout. Design and layout are subject to change without notice.

©2008 Royal Caribbean Cruises Ltd. All rights reserved

